



NC DEPARTMENT OF
**HEALTH AND
HUMAN SERVICES**

ROY COOPER • Governor

MANDY COHEN, MD, MPH • Secretary

MARK PAYNE • Director, Division of Health Service Regulation

May 30, 2019

Kenneth Burgess
301 Fayetteville Street, Suite 1900
Raleigh, NC 27601

Exempt from Review - Replacement Equipment

Record #: 2957
Facility Name: Mission Hospital
FID #: 943349
Business Name: HCA Healthcare, Inc.
Business #: 2948
Project Description: Replace MRI scanner #1 and renovate the MRI room at Memorial Mission campus
County: Buncombe

Dear Mr. Burgess:

The Healthcare Planning and Certificate of Need Section, Division of Health Service Regulation (Agency) received your correspondence regarding the above referenced proposal. Based on the CON law **in effect on the date of this response to your request**, the proposal described in that correspondence is not governed by, and therefore, does not currently require a certificate of need. If the CON law is subsequently amended such that the above referenced proposal would require a certificate of need, this determination does not authorize you to proceed to develop the above referenced proposal when the new law becomes effective.

You may need to contact the Agency's Construction and Acute and Home Care Licensure and Certification Sections to determine if they have any requirements for development of the proposed project.

This determination is binding only for the facts represented in your correspondence. If changes are made in the project or in the facts provided in the correspondence referenced above, a new determination as to whether a certificate of need is required would need to be made by this office.

Please do not hesitate to contact this office if you have any questions.

Sincerely,

Ena Lightbourne
Project Analyst

Martha J. Frisone, Chief
Healthcare Planning and Certificate of Need Section

cc: Construction Section, DHSR
Acute and Home Care Licensure and Certification Section, DHSR

NC DEPARTMENT OF HEALTH AND HUMAN SERVICES • DIVISION OF HEALTH SERVICE REGULATION

HEALTHCARE PLANNING AND CERTIFICATE OF NEED SECTION

LOCATION: 809 Ruggles Drive, Edgerton Building, Raleigh, NC 27603
MAILING ADDRESS: 2701 Mail Service Center, Raleigh, NC 27699-2701
www.ncdhhs.gov/dhsr/ • TEL: 919-855-3750 • FAX: 919-733-2757

AN EQUAL OPPORTUNITY / AFFIRMATIVE ACTION EMPLOYER



Poyner Spruill^{LLP}

May 20, 2019

Kenneth L. Burgess
Partner
D: 919.783.2917
F: 252.972.7045
kburgess@poynerspruill.com

VIA EMAIL

Lisa Pittman, Assistant Chief
Gloria Hale, Team Leader
Healthcare Planning and Certificate of Need Section
N.C. Department of Health and Human Services
Division of Health Service Regulation
809 Ruggles Drive
Raleigh, North Carolina 27603

RE: *MH Mission Hospital, LLLP Notice of Exemption For Replacement Of MRI*

Dear Lisa and Gloria:

Our law firm represents MH Mission Hospital, LLLP, a Delaware limited liability limited partnership and holding company of HCA Healthcare, Inc. ("Mission"). Mission owns and operates an existing MRI Scanner located in Room A205.01 at the Memorial Mission campus, 509 Biltmore Avenue, Asheville, N.C. ("MRI #1"). Mission plans to replace MRI #1 at the same site and in the same room at the Mission Memorial facility, the details of which are explained below ("the Project"). The purpose of this letter is to request that the N.C. Department of Health and Human Services, Division of Health Service Regulation, Healthcare Planning and Certificate of Need Section ("the CON Section") confirm that the replacement of Mission's MRI #1 is exempt from certificate of need ("CON") review within the meaning of N.C. Gen. Stat. §131E-184(f) and that Mission can proceed to acquire and install the new MRI Scanner without a CON.

Background

The existing MRI #1 at Mission Imaging is a Philips Inginia 3T scanner. That scanner was purchased new in 2010 and is nearing the end of its useful life. As such, Mission plans to replace the scanner at the same site and in the same physical location at Mission as the existing scanner. Room A205.01, which is the site of the existing MRI Scanner and will be the site of the replacement MRI Scanner, requires certain upgrades to accommodate the new equipment. For the reasons set forth below, Mission's replacement of MRI #1 and related renovations to Room A205.01 are exempt from CON review pursuant to N.C. Gen. Stat. §131E-184(f).

Applicable Legal Authorities

The CON Law precludes any person from offering or developing a "new institutional health service" without first obtaining a CON. N.C. Gen. Stat. § 131E-178(a). The definition of "new institutional health service" includes, *inter alia*, the following:

- Incurring an obligation for a capital expenditure that exceeds \$2,000,000.00 to develop or expand a health service or health service facility, or which "relates" to the provision of a health service; and
- The acquisition by purchase, donation, lease, transfer or comparable arrangement of "major medical equipment," which is defined as a single unit or single system of components used to

provide medical and health services which costs more than \$750,000.00, including the costs of the equipment and all studies, drawings, installation and any other activities essential to acquiring and making the equipment operational.

N.C. Gen. Stat. §§ 131E-176(16)(b), (16)(p) and (14o). These provisions, taken together, would require that an entity proposing to acquire medical equipment which costs more than \$2,000,000 apply for and obtain a CON before acquiring the equipment.

However, the CON Law provides at N.C. Gen. Stat. § 131E-176(14o) that "replacement equipment" as defined at N.C. Gen. Stat. § 131E-176(22a) does not constitute "major medical equipment."¹ In addition, the CON Law contains a specific exemption applicable to "replacement equipment" that costs more than \$2,000,000.00. N.C. Gen. Stat. § 131E-184(f). This exemption, where applicable, eliminates the need to obtain a CON before acquiring and installing replacement equipment. This exemption is described below.

Statutory Exemption For Replacement Equipment Which Costs More Than \$2,000,000

To qualify as "replacement equipment" under the CON Statute, medical equipment must:

- Be purchased for the sole purpose of replacing comparable medical equipment currently in use which will be sold or otherwise disposed of when replaced. In calculating the total cost of the replacement equipment, the costs of the equipment, studies, surveys, designs, plans, working drawings, specifications, construction, installation, and other activities essential to acquiring and making operational the replacement equipment shall be included. The capital expenditure for the equipment shall be deemed to be the fair market value or the cost of the equipment, whichever is greater.

N.C. Gen. Stat. §131E-176(22a).

Replacement equipment is "comparable" to the equipment being replaced if:

1. It has the same technology as the equipment currently in use, although it may possess expanded capabilities due to technological improvements;
2. It is functionally similar and is used for the same diagnostic or treatment purposes as the equipment currently in use and is not used to provide a new health service; and
3. The acquisition of the equipment does not result in more than a 10% increase in patient charges or per procedure operating expenses within the first twelve months after the replacement equipment is acquired.

10A N.C. Admin. Code 14C .0303(d)(1)-(3).²

¹ Major medical equipment, by definition, consists of a single unit or system of units with related functions which is used to provide medical and other health services and which costs more than \$750,000. N.C. Gen. Stat. § 131E-176(14o). The acquisition of major medical equipment requires a CON. However, where medical equipment qualifies as "replacement equipment" under the CON Statute, it does not count as "major medical equipment" and can be acquired without a CON, assuming the acquisition also satisfies certain other exemption-related elements as described in this correspondence. N.C. Gen. Stat. §§ 131E-184(a)(7) and (f).

² Pursuant to 10A NCAC 14C .0303, equipment does not qualify as "replacement equipment" where equipment which was second-hand or reconditioned is being replaced with new equipment within three (3) years of the acquisition of the equipment being replaced, or leased equipment is being replaced with

Where the replacement equipment costs more than \$2,000,000, two additional statutory criteria apply, as follows:

1. The equipment being replaced is located on the main campus; and
2. The Department of Health and Human Services has previously issued a CON for the equipment being replaced, unless a CON was not required at the time the equipment was purchased by the licensed health service facility.

An entity seeking to qualify under the replacement equipment exemption at N.C. Gen. Stat. § 131E-184(f) must provide to the CON Section advance written notice of the acquisition, including an explanation of how the equipment acquisition meets the requirements set forth above. This letter is being submitted to the CON Section on behalf of Mission to satisfy this advance notice requirement.

The Replacement of MRI Scanner #1 By Mission Qualifies
Under the Exemption Set Forth at N.C. Gen. Stat. § 131E-184(f)

The replacement of MRI Scanner # 1 at Mission fits within the parameters of the exemption at N.C. Gen. Stat. § 131E-184(f) because:

1. The equipment being upgraded is currently in use at Mission. See Attachment 1.
2. The total estimated cost of the project is \$2,942,411.00,³ placing the project within the parameters of the statutory exception set forth at N.C. Gen. Stat. §131E-184(f). The total project costs consist of equipment costs of \$1,891,973.00⁴, related construction and materials costs, architect and engineering fees and a generous contingency. See Attachment 2 (certified Total Capital Cost Worksheet) and Attachment 3 (applicable excerpt of price quotation from Siemens Healthineers for MRI system and various vendor quotes for items reflected on Attachment 2, the capital cost worksheet, under item (c)(14), Movable Equipment Purchase/Lease)⁵.

purchased equipment. The existing MRI scanner which is being upgraded was purchased new in 2010. As such, 10A NCAC 14C .0103 does not apply to this Project.

³ In calculating construction costs, our clients relied upon prior Agency determinations that the construction costs "essential to acquiring and making operational the replacement equipment" should include only those costs directly related to removing the old equipment, installing the new equipment and making sure that equipment operates properly. In the case of a CT scanner, for example, such cost should include upfit of the CT room related solely to the operation of the CT scanner (e.g., shielding, extra electrical connections), but need not include other construction costs associated with that room. Similarly, the Agency has previously determined that costs associated with the installation of equipment in the control room for the CT scanner should be included only to the extent that those costs would be different from construction related to general office space. Mission Hospitals, Inc. v. NC DHHS, ___ N.C.App. ___, 696 S.E.2d 163 (2010).

⁴ This total includes \$1,495,234.00 which is the cost of the MRI system itself, and an additional \$396,730.00 of related support and ancillary equipment. This total likely includes items of equipment which do not qualify as "major medical equipment" under the CON Statute, but we have included them in the interest of being comprehensive.

⁵ Any variances between the actual vendor quotes contained at Attachment 3 and the total expenditure reflected on Attachment 2 at item (c)(14) result either from: i) the rounding up of costs; ii) the removal from the included quotes of certain training expenditure line items which are not required to be counted as major medical expense costs; or iii) the removal of sales tax from the purchase price totals because those sales taxes have been included in line item (c)(20) on Attachment 2, entitled "Other(contingency/sales

Lisa Pittman, Assistant Chief
May 20, 2019
Page 5

Poyner Spruill^{LLP}

Please feel free to let me know if you have questions or need additional information regarding this project.

Very truly yours,



Kenneth L. Burgess
Partner

cc: Garrett Shreffler
Sonya Greck
Karen Patton
Toby Kay
Jon Yeatman

Attachments

3. The existing Philips Inginia 3T scanner will be sold or otherwise disposed of when the replacement equipment is acquired and installed, and will not be reinstalled or used in North Carolina without appropriate CON Section authorization. See Attachment 4 (letter from Siemens Healthineers regarding removal of existing MRI # 1).
4. The new MRI scanner will have the same capabilities as the scanner being replaced, although it may have additional capabilities due to the advancement of MRI Scanner technology, is functionally similar to the existing MRI Scanner and will be used for the same diagnostic or treatment purposes as the equipment being upgraded. See Attachment 1.
5. The Project will not increase patient charges or per procedure operating expenses more than 10% within 12 months of the replacement equipment being installed and becoming operational. See Attachment 1.
6. The equipment is being replaced on the hospital's main campus. The term "campus" is defined at N.C. Gen. Stat. § 131E-176(2c) as "the adjacent grounds and buildings, or grounds and buildings not separated by more than a public right-of-way, of a health service facility and related health care entities." The term "main campus" is defined as the site of the main building from which a licensed health service facility provides clinical patient services and exercises financial and administrative control over the entire facility, including the buildings and grounds adjacent to that main building or other areas and structures which are not strictly contiguous to the main building but are within 250 yards of the main building." N.C. Gen. Stat. §131E-176(14n). The existing MRI # 1 is currently located in the main hospital building at Mission. The replacement equipment for MRI # 1 will be located at the same site, in the same room, at Mission's main hospital building. That building is also the cite from which Mission provides clinical patient services and exercises financial and administrative control over the Mission hospital facility. See Attachment 5 (diagrams showing location of the Memorial Mission building which is the location of clinical and administrative services at Mission and the building which houses Room A205.01).
7. Finally, the CON Section has previously issued a CON for the equipment being replaced or a CON was not required at the time the equipment being replaced was acquired. See Attachment 6 (copy of CON for existing MRI # 1, issued on May 4, 2010).

Conclusion

For the reasons set forth herein, we believe that the replacement of Mission's existing MRI #1 is exempt from CON review and that no CON is required for the Project. We respectfully request that the CON Section provide written confirmation that Mission may proceed with the Project as described without CON Section Review and without obtaining a CON.

tax)." We have included blank divider sheets between each of the component equipment quotes for the convenience of the Agency.

ATTACHMENT 1



January 15, 2019

Re: Information/Items Needed for MRI scanner replacement Exemption Letter to CON Section

To Whom It May Concern:

Mission Hospital will be replacing our existing MRI scanner that is physically located at Memorial Main Campus, 509 Biltmore Avenue in Asheville, NC, Radiology Department, Room A205.01. The scanner to be replaced is currently in use. The replacement of this scanner will not result in more than a 10% increase in patient charges or per procedure operating expense within the first twelve months after replacement. The scanner being replaced was purchased new when acquired and the replacement scanner will be a new unit. All new functionality associated with the new scanner will be due to advancement of technology. The existing equipment will be traded in as part of the purchase of the new equipment.

Best Regards,

A handwritten signature in cursive script that reads "Libby Dore".

Libby Dore, MBA, CRA, RT(R), (BD)

Executive Director, Imaging Services
509 Biltmore Avenue
Asheville, NC 28801
828-213-1333
libby.dore@msj.org

ATTACHMENT 2

PROPOSED TOTAL CAPITAL COST OF PROJECT

Project Name: MMH MRI #1 Replacement

Provider/Company: Mission Hospital

A. Site Costs

(1) Full purchase price of land.....		\$ ---	
Acres			
Price per Acre	\$ ---		
(2) Closing costs.....		\$ ---	
(3) Site Inspection and Survey.....		\$ ---	
(4) Legal fees and subsoil investigation		\$ ---	
(5) Site Preparation Costs			
Soil Borings.....	\$ ---		
Clearing-Earthwork...	\$ ---		
Fine Grade For Slab...	\$ ---		
Roads-Paving.....	\$ ---		
Concrete Sidewalks...	\$ ---		
Water and Sewer.....	\$ ---		
Footing Excavation....	\$ ---		
Footing Backfill.....	\$ ---		
Termite Treatment....	\$ ---		
Other (Specify).....	\$ ---		
Sub-Total Site Preparation Costs		\$ ---	
(6) Other (Specify)		\$ ---	
(7) Sub-Total Site Costs			\$ 0

B. Construction Contract

(8) Cost of Materials			
General Requirements	\$ ---		
Concrete/Masonry	\$ ---		
Woods/Doors & Windows/Finishes	\$ ---		
Thermal & Moisture Protection	\$ ---		
Equipment/Specialty Items	\$ ---		
Mechanical/Electrical	\$ ---		
Other (Specify)	\$ ---		
Sub-Total Cost of Materials.....		\$407,400	
(9) Cost of Labor.....		\$271,600	
(10) Other (misc. project development).....		\$50,000	
(11) Sub-Total Construction Contract			\$729,000

C. Miscellaneous Project Costs

(12) Building Purchase.....		\$ ---	
(13) Fixed Equipment Purchase/Lease		\$1,495,234	
(14) Movable Equipment Purchase/Lease		\$396,739	
(15) Furniture		\$ ---	
(16) Landscaping		\$ ---	
(17) Consultant Fees			
Architect and Engineering Fees	\$78,000		
Legal Fees.....	\$ ---		
Market Analysis.....	\$ ---		
Other (Specify).....	\$ ---		
Other (Commissioning).....	\$10,000		
Sub-Total Consultant Fees.....		\$88,000	
(18) Financing Costs (e.g. Bond, Loan, etc.)		\$ ---	
(19) Interest During Construction.		\$ ---	
(20) Other (contingency, sales tax)		\$233,438	
(21) Sub-Total Miscellaneous			\$2,213,411
(22) Total Capital Cost of Project (Sum A-C above)			\$2,942,411

I certify that, to the best of my knowledge, the above construction related costs of the proposed project named above are complete and correct.

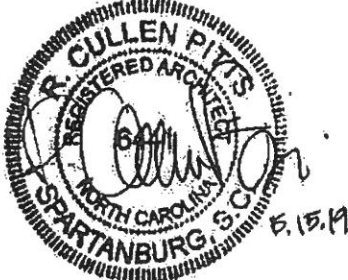

(Signature of Licensed Architect or Engineer)

I assure that, to the best of my knowledge, the above capital costs for the proposed project are complete and correct and that it is my intent to carry out the proposed project as described.

 05.16.2019
Director of Facility Planning Design & Construction (Signature of Office Authorized to Represent Provider/Company)

ATTACHMENT 3

Siemens Medical Solutions USA, Inc.
40 Liberty Boulevard, Malvern, PA 19355
Fax: (866) 309-6967



SIEMENS REPRESENTATIVE
Karen Dixon - (865) 360-8644

PRELIMINARY PROPOSAL

Customer Number: 0000030137

Date: 4/19/2019

MISSION HOSPITAL INC
509 BILTMORE AVE
ASHEVILLE, NC 28801-4601

Estimated Delivery Date: 8/2019

Estimated delivery date is subject to change based upon factory lead times, acceptance date of this quote, customer site readiness, and other factors. A Siemens representative will contact you regarding the final delivery date.

This proposal includes the trade-in of equipment referenced in Trade Sheet Project # 2018-1719.

This offer is only valid if a firm, non-contingent order is placed with Siemens by April 30, 2019 and delivery will be accepted within 4 months of issuing the non-contingent Purchase order.

Quote Nr: **1-OPNSMC Rev. 14**

MAGNETOM Sola

All items listed below are included for this system: *(See Detailed Technical Specifications at end of Proposal.)*

Qty	Part No.	Item Description	Extended Price
1	14460300	MAGNETOM Sola - System MAGNETOM Sola - the first 1.5T BioMatrix system - leverages the intelligent combination of Tim 4G and the Siemens unique BioMatrix technology to be ready to embrace the unique set of challenges that each and every patient brings to the MRI exam. System Design - Short and open appearance (157 cm total system length cover-to-cover and 70 cm Open Bore Design) to reduce patient anxiety and claustrophobia - Whole-body superconductive Zero Helium Boil-Off 1.5T magnet - Weight-optimized magnet technology based on high performance 3T and 7T magnet design - Actively Shielded water-cooled Siemens gradient system for maximum performance Evolving from Total imaging matrix, MAGNETOM Sola comprises a new technology that addresses the intrinsic biovariability in humans - BioMatrix Technology. BioMatrix Technology is designed to address different aspects of patient variability and is built on three key technological clusters: BioMatrix Sensors: anticipate challenges before they happen with respiratory sensors integrated in the spine coil to measure the patient's respiratory signal as soon as the patient is on the table in either head-first or feet-first position.	\$688,500

Siemens Medical Solutions USA, Inc.
 40 Liberty Boulevard, Malvern, PA 19355
 Fax: (866) 309-6967



SIEMENS REPRESENTATIVE
 Karen Dixon - (865) 360-8644

PRELIMINARY PROPOSAL

Qty	Part No.	Item Description	Extended Price
		<p>BioMatrix Tuners: adapt and correct the field inhomogeneities induced by patient's individual anatomies with CoilShim and SliceAdjust technologies for robust and repeatable IQ.</p> <p>BioMatrix Interfaces: easily manage any type of patient with intelligent interfaces such as Select&GO panels to accelerate workflow without compromising quality.</p> <p>Tim 4G (Total imaging matrix in the 4th generation) for excellent image quality and speed</p> <ul style="list-style-type: none"> - Siemens unique DirectRX technology enabling all digital-in/digital-out design - Dual-Density Signal Transfer Technology <hr/> <p>Push-button exams with GO technologies</p> <ul style="list-style-type: none"> Select&GO DotGO Recon&GO MR View&GO <p>Tim Application Suite allowing excellent head-to-toe imaging</p> <ul style="list-style-type: none"> - Neuro Suite - Angio Suite - Cardiac Suite - Body Suite - Onco Suite - Breast Suite - Ortho Suite - Pediatric Suite - Scientific Suite 	
1	14456328	<p>BioMatrix Technology #Vi</p> <p>The new and unique BioMatrix technology addresses the different aspects of patient bio-variability. It is based on three technological clusters:</p> <ul style="list-style-type: none"> - BioMatrix Sensors address patient physiology, in order to anticipate challenges - BioMatrix Tuners address patient anatomy, in order to adapt to all patients, especially critical ones. - BioMatrix Interfaces address user interaction with the patient, to accelerate the workflow in the face of patient variability. 	\$1
1	14460161	<p>MR General Engine #Vi</p> <p>syngo.MR General Engine extends Numaris/X by adding dedicated workflows and tools for routine and advanced reading of MR examinations.</p> <p>A generic MR Basic workflow is provided, as well as specific MR Neurology, MR Prostate Reading, MR Breast Reading, and MR Cardio-Vascular workflows.</p>	\$1
1	14456321	<p>Brain Dot Engine #Se</p> <p>The Brain Dot Engine provides guided and automated workflows customizable to the site specific standards of care for general brain examinations. The Brain Dot Engine supports the user in achieving reproducible image quality with increased ease of use and time efficient exams.</p> <p>The brain workflow can be personalized to the individual patient condition and clinical need. Several predefined strategies are included, which can be easily selected with one click. They can be changed at any time during the brain workflow.</p>	\$0
1	14461775	<p>DotGO Routine Package #BM</p> <p>The DotGO Routine Package includes both:</p>	\$1

Siemens Medical Solutions USA, Inc.
 40 Liberty Boulevard, Malvern, PA 19355
 Fax: (866) 309-6967



SIEMENS REPRESENTATIVE
 Karen Dixon - (865) 360-8644

PRELIMINARY PROPOSAL

Qty	Part No.	Item Description	Extended Price
		- Spine Dot Engine and - Large Joint Dot Engine.	
		As a package they offer a comprehensive set of workflows with guidance and automation, for standardized image quality in Spine and MSK MR imaging. The Spine Dot Engine provides the functionality of Inline Composing and Tim Planning Suite for streamlining workflows in all spine imaging. Tools, such as auto-positioning and vertebral recognition with AutoAlign Spine, AutoCoverage and Spine Labelling support and optimize reproducibility for your cervical, thoracic and lumbar spine imaging for all clinical indications. The Large Joint Dot Engine enhances standardization of the knee, hip and shoulder workflows and optimizes reproducible image quality by incorporating automation tools, such as anatomically based auto-positioning (AutoAlign). Dedicated imaging techniques, such as Advanced WARP, are included and can help to expand the access of diagnostic MRI to a broader range of patient types.	
1	14441748	Quiet Suite #T+D Quiet Suite enables complete, quiet examinations for neurology and orthopedics with at least 70% reduction in sound pressure levels.	\$0
1	14460162	Tim Whole Body Suite #Vi Tim Whole Body Suite puts it all together. This suite enables table movement for imaging of up to 205 cm (6' 9") FoV without compromise. In combination with Tim's newly designed ultra-high density array higher spatial and temporal resolution can be achieved along with unmatched flexibility of any coverage up to Whole Body. For faster exams and greater diagnostic confidence.	\$1
1	14460227	Tim Planning Suite #Vi With the Tim Planning Suite, multiple regions in the entire body can be examined in a minimum of time through measurement planning on a single FoV of any desired size.	\$1
1	14456329	syngo TimCT FastView #Vi TimCT FastView is the one go localizer for the whole body or large body regions such as the whole spine or the whole abdomen. It acquires the complete extended Field of View in one volume with isotropic resolution. Transverse, coronal and sagittal reformats of the volume are calculated Inline and displayed for planning subsequent exams. - Inline reconstruction of the localizer images during the scan. - Localizing images in three planes over the maximum Field of View available for subsequent planning in all orientations. - TimCT FastView runs without laser light positioning to further streamline the workflow for several indications.	\$1
1	14460160	Advanced Diffusion #Vi QuietX DWI and RESOLVE together make up the Advanced Diffusion package. QuietX DWI enables quieter diffusion-weighted imaging of the brain with up to 70% reduction in sound pressure relative to conventional diffusion-weighted imaging. RESOLVE (Readout Segmentation Of Long Variable Echo-trains) is a multi-shot, readout segmented EPI sequence for high-resolution, low-distortion diffusion-weighted imaging (DWI). This technique is largely insensitive to susceptibility effects, providing anatomically accurate diffusion imaging for the brain, spine, breast and prostate. In combination with syngo.MR Tractography, RESOLVE enables excellent white-matter tract imaging even in regions of high susceptibility, such as the spine.	\$1
1	14456327	WARP & Advanced WARP #Vi WARP and Advanced WARP (SEMAC) integrates different techniques tailored to reduce susceptibility artifacts caused by orthopedic MR-conditional metal implants.	\$1

Siemens Medical Solutions USA, Inc.
 40 Liberty Boulevard, Malvern, PA 19355
 Fax: (866) 309-6967



SIEMENS REPRESENTATIVE
 Karen Dixon - (865) 360-8644

PRELIMINARY PROPOSAL

Qty	Part No.	Item Description	Extended Price
1	14456237	Advanced Cardiac incl. PSIR #Vi This package contains special sequences and protocols for advanced cardiac imaging including 3D and 4D BEAT functionalities. It supports advanced techniques for ventricular function imaging, dynamic imaging, tissue characterization, coronary imaging, and more.	\$1
1	14456323	Inline Composing syngo #Se Automatic anatomical or angiographic composing of multiple adjacent coronal or sagittal images for presentation and further evaluation. Composed images can be automatically loaded into Graphical Slice Positioning for scan planning purposes.	\$0
1	14456281	syngo Expert-i This software application enables remote access to the system (connected via local area network) for planning and processing.	\$1
1	14460303	Tim [204x48] XQ Gradient #So Tim [204x48] XQ-gradients performance level Tim 4G's RF system and innovative coil architecture enables high-resolution imaging and increased throughput. The system provides a maximum number of 204 channels (coil elements) that can be connected simultaneously. Flexible parallel imaging is achieved by the standard 48 independent RF channels that can be used simultaneously in one single scan and in one single FOV, each generating an independent partial image. This option includes also Advanced High Order Shim. XQ - gradients The XQ 45/200 gradients are designed for high performance and linearity to support clinical whole body imaging at 1.5T. The XQ gradients combine 45 mT/m peak amplitude with a slew rate of 200 T/m/s. The force compensated gradient system minimizes vibration levels and acoustic noise. High-performance measurement and reconstruction system.	\$182,250
1	14460306	Standard Coil Package, 48-ch #So This package includes: - BioMatrix Head/Neck 20 tiltable with CoilShim - BioMatrix Spine 32 with Respiratory Sensors - Body 18 - Flex Large 4 - Flex Small 4 - Flex Coil Interface	\$60,750
1	14460415	BioMatrix Dock. Table w/ eDrive #So The BioMatrix Dockable Table with eDrive is designed for maximum patient comfort and smooth patient preparation. The BioMatrix Dockable Table with eDrive can support up to 250 kg (550 lbs) without restricting the vertical or horizontal movement. The BioMatrix eDrive provides motorized assistance for easy maneuverability of the table.	\$44,550
1	14460410	Silver & White Design #So MAGNETOM Sola is available in two different light and appealing design variants which perfectly integrate into different environments. The Silver & White Design Variant comprises a brilliant white front design ring with integrated unique Select&GO panels. The smoothly embracing deco area on the left side and the outer rings in the front and the back of the system is colored in brilliant silver. The table cover is presented also in the same color and material selection.	\$1

Siemens Medical Solutions USA, Inc.
 40 Liberty Boulevard, Malvern, PA 19355
 Fax: (866) 309-6967



SIEMENS REPRESENTATIVE
 Karen Dixon - (865) 360-8644

PRELIMINARY PROPOSAL

Qty	Part No.	Item Description	Extended Price
1	14456270	PC Keyboard US English #Vi Standard PC keyboard with 105 keys.	\$1
1	14460419	High-End Computing [204x48] #So Tim 4G power computing upgrade for MAGNETOM Sola Tim [204x48]. This upgrade brings a high-end image reconstruction computer to the Tim [204x48] configuration.	\$32,400
1	14456238	Peripheral Pulse Unit #Vi Peripheral Pulse Unit for Pulse Triggering	\$3,038
1	14402527	SWI #Tim Susceptibility Weighted Imaging is a high-resolution 3D imaging technique for the brain with ultra-high sensitivity for microscopic magnetic field inhomogeneities caused by deoxygenated blood, products of blood decomposition and microscopic iron deposits. Among other things, the method allows for the highly sensitive proof of cerebral hemorrhages and the high-resolution display of venous cerebral blood vessels.	\$10,125
1	14456232	DTI Package #Vi This package combines Diffusion Tensor Imaging and syngo.MR Tractography.	\$25,110
1	14416946	Neuro Perfusion Package #T+D The Neuro Perfusion Package helps to streamline the clinical workflow by inline post-processing in dynamic susceptibility contrast (DSC) based perfusion imaging. This makes it possible to see perfusion maps immediately. Perfusion parameter maps are based on a Local Arterial Input function. A corrected rCBV map calculation and motion correction is provided.	\$6,075
1	14460171	syngo.MR Neuro Perfusion Engine #1 syngo.MR Neuro Perfusion Engine extends the MR Neurology workflow with a complete package for advanced processing and evaluation of brain perfusion datasets	\$14,175
1	14416923	Abdomen Dot Engine #T+D The Abdomen Dot Engine: Personalized Exam Strategies - Guidance - Automatic sequence scaling - Auto Navigator - Auto-FoV - Timeline setup and monitoring - Automatic Voice Commands - Auto Bolus Detection - Inline radial range calculation for MRCP - Inline Subtraction - Inline Registration	\$24,300
1	14441761	LiverLab #T+D LiverLab is a system guided workflow to examine the hepatic fat and iron status, as part of the Abdomen Dot Engine.	\$18,225
1	14456267	CS GRASP-VIBE #Vi Compressed Sensing GRASP-VIBE (Golden-Angle Radial Sparse Parallel) makes it possible to conduct dynamic contrast-enhanced abdominal exams in free breathing. Acquisition is performed in one continuous run, using a golden-angle stack-of-stars radial scheme that confers robustness towards motion and the flexibility to choose the temporal resolution at reconstruction time. The temporal resolution may even vary over the duration of the scan. Reconstruction is performed using a Compressed Sensing accelerated iterative algorithm with per-voxel through-time regularization. The combination of features enables for free-breathing abdominal exams with both robust diagnostic image quality and the high temporal resolution required to capture the dynamic phases of contrast enhancement. Additional features: - Auto Bolus Detection at reconstruction time - Configuration of exam phases in terms of start time relative to the auto-detected bolus arrival, duration, temporal resolution, and pre-selection for export to PACS - Self-gating for further reduction of residual motion blur	\$26,325

Siemens Medical Solutions USA, Inc.
 40 Liberty Boulevard, Malvern, PA 19355
 Fax: (866) 309-6967



SIEMENS REPRESENTATIVE
 Karen Dixon - (865) 360-8644

PRELIMINARY PROPOSAL

Qty	Part No.	Item Description	Extended Price
		- Includes FREEZEit+ #Vi	
1	14409198	Native syngo #Tim Integrated software package with sequences and protocols for non-contrast enhanced 3D MRA with high spatial resolution. syngo NATIVE particularly enables imaging of abdominal and peripheral vessels and is an alternative to MR angiography techniques with contrast medium, especially for patients with severe renal insufficiency.	\$20,250
1	14441813	QISS #T+D Software package with QISS sequence, protocols and Dot AddIn for non-contrast enhanced peripheral MRA. QISS particularly enables higher reproducibility than existing methods and is an alternative to MR angiography techniques with contrast medium, especially for patients with severe renal insufficiency.	\$8,100
1	14418746	Cardiac Dot Engine, USA #T+D Cardiac examinations: Dot Cardiac - Customized workflows that are easier to repeat. Using anatomical landmarks, standard views of the heart (such as dedicated long axis and short-axis views), are easily generated and can easily be reproduced using different scanning techniques. Scan parameters are adjusted to the patient's heart rate and automatic voice commands are given.	\$36,450
1	14456227	CS Cardiac Cine #Vi This option enables the BEAT sequence to perform highly accelerated 2D Cardiac Cine examinations based on a Compressed Sensing technique. It allows higher temporal resolution imaging in real time or in segmented mode, without compromising on spatial resolution. Protocols are provided for full coverage of the heart within a single breath-hold for quantitative functional assessment. In real-time mode, it is robust against arrhythmia and breathing artifacts.	\$16,200
1	14441747	MyoMaps #T+D This package contains special sequences and protocols for inline T1,T2 and T2* calculation at the heart. The generation of T1 and T2 parametric maps is enhanced by the use of motion correction. T1,T2 and T2* parametric maps could be used to support assessment of cardiovascular disease.	\$16,200
1	08464740	Flow Quantification #Tim Special sequences for quantitative assessment of flow.	\$8,100
1	14456247	syngo.MR Cardiac Flow #1 syngo.MR Cardiac Flow processes velocity-encoded MR images to evaluate blood flow dynamics e.g. in the heart and the great vessels. The application generates quantitative results for physicians in the diagnostic process. The MR cardiac interactive reporting template is included.	\$7,290
1	14456252	syngo.MR Cardiac 4D Ventr. Funct.#1 syngo.MR Cardiac 4D Ventricular Function processes MR cine images of the heart and generates quantitative results for physicians in the diagnostic process. MR cardiac interactive reporting template included.	\$14,175
1	14461619	Turbo Suite Essential #BM Turbo Suite Essential comprises established acceleration techniques to maximize productivity for all contrasts, orientations and all routine imaging applications from head-to-toe.	\$0
1	14461558	Simultaneous Multi-Slice Package #BM This license includes: - Simultaneous Multi-Slice EPI. Simultaneous Multi-Slice (SMS) EPI enables accelerated imaging for diffusion-weighted (DWI/DTI) and BOLD functional MR imaging. With SMS EPI, scan times for DWI can be reduced by up to 68% and/or images with higher spatial/diffusion resolution can be acquired. For BOLD imaging, SMS EPI can enable increased temporal sampling of BOLD data acquisitions and/or improved slice	\$18,225

Siemens Medical Solutions USA, Inc.
 40 Liberty Boulevard, Malvern, PA 19355
 Fax: (866) 309-6967



SIEMENS REPRESENTATIVE
 Karen Dixon - (865) 360-8644

PRELIMINARY PROPOSAL

Qty	Part No.	Item Description	Extended Price
1	14441809	<p>coverage/resolution.</p> <p>Body 30 #1.5T</p> <p>The Tim 4G coil technology with Dual Density Signal Transfer and SlideConnect Technology combines key imaging benefits: excellent image quality, high patient comfort, and unmatched flexibility:</p> <ul style="list-style-type: none"> - 30 channels or up to 46 (in combination with the Spine 32) - Dual Density Signal Transfer - Ultra light-weight - Highly flexible viscoelastic material - SlideConnect Technology <p>The Body 30 features:</p> <ul style="list-style-type: none"> - 30-element design with 30 integrated preamplifiers (5 clusters of 6 elements each) - Can be combined with further coils for larger coverage - Can be positioned in different orientations (0°, 90°, 180°, 270°) for patient specific adaptations - No coil tuning - IPAT compatible in all directions <p>The highly flexible design allows the usage for:</p> <ul style="list-style-type: none"> - Thorax (incl. heart) - Abdomen - Pelvis (incl. prostate) - Hip - Angiography <p>Dedicated protocols are provided for abdominal imaging.</p> <p>Typically combined with:</p> <ul style="list-style-type: none"> - Spine 32 - Body 18 - Body 18 long (optional) - Peripheral Angio 36 (optional) - Body 30 (optional) 	\$40,500
1	14460315	<p>Shoulder Shape 16 #So</p> <p>The Shoulder Shape 16 combines the known benefits of Tim 4G coil technology with new highly flexible materials, resulting in unmatched image quality, high patient comfort and easy handling. The Shoulder Shape 16 for examinations of the left or right shoulder consists of an iPAT-compatible 16-channel shoulder coil in a flexible shoulder cup that can be shaped around small and large shoulders. An L-shaped cushion for easy positioning of the patient is included. The 16-element coil with 16 integrated pre-amplifiers ensures maximum signal-to-noise ratio. Shoulder Shape 16 will be connected via a SlideConnect plug for fast and easy coil set-up and patient preparation.</p>	\$24,300
1	14460423	<p>Tx/Rx Knee 18 #So</p> <p>New 18-channel transmit/receive coil optimized for knee imaging. The spacious design with a flared opening towards the thigh allows scanning even of large and swollen knees with exceptional image quality and signal to noise ratio.</p> <p>Main features :</p> <ul style="list-style-type: none"> - 18-element design (3x6 coil elements) with 18 integrated preamplifiers - iPAT-compatible - SlideConnect Technology 	\$32,400

Siemens Medical Solutions USA, Inc.
 40 Liberty Boulevard, Malvern, PA 19355
 Fax: (866) 309-6967



SIEMENS REPRESENTATIVE
 Karen Dixon - (865) 360-8644

PRELIMINARY PROPOSAL

Qty	Part No.	Item Description	Extended Price
1	14416962	<p>Foot/Ankle 16 #Ae</p> <p>The new Tim 4G coil technology with Dual Density Signal Transfer and DirectConnect Technology combines key imaging benefits: excellent image quality, high patient comfort, and unmatched flexibility.</p> <p>Foot/Ankle 16 for examinations of the left or right foot and ankle region consists of a base plate and an iPAT compatible 16-channel coil and allows high-resolution imaging of the foot and ankle within one examination. Foot/Ankle 16 is a cable-less coil and will be connected via DirectConnect for fast and easy patient preparation.</p>	\$30,375
1	14426332	<p>Tx/Rx CP Head Coil #Ae</p> <p>Circularly polarized no-tune transmit/receive coil with an open patient-friendly design. The integrated transmit mode allows volume selective excitation. Integrated, extremely low-noise pre-amplifiers permit very high signal-to-noise ratio. Furthermore, the coil is outfit with SlideConnect Technology, allowing for easier patient preparation and less table time for the patient.</p>	\$32,400
1	14460421	<p>UltraFlex Small 18 #So</p> <p>Light-weight, iPAT compatible, 18-element no-tune receive coil made of highly flexible and soft viscoelastic material. It is used for examinations of smaller extremities (e.g. small to medium shoulder, smaller ankle, elbow and hand) and for abdominal examinations. A dedicated positioning aid for smaller extremities, like ankle or elbow is delivered with the coil.</p>	\$24,300
1	14456282	<p>Positioning Aids Shoulder&Ankle #Vi</p> <p>This package contains additional positioning aids that can be used for the UltraFlex Large 18 and UltraFlex Small 18.</p>	\$1,500
1	14416952	<p>Coil Storage Cart #T+D</p> <p>Specially designed non-ferromagnetic cart for easy storage of the most commonly used coils and accessories.</p>	\$2,025
1	14407259	<p>MR Workplace Table, height adjust.</p> <p>The table is suitable for the syngo Acquisition Workplace and the syngo MR Workplace based on syngo hardware.</p> <p>This 110V version has motorized table height adjustment.</p>	\$1,013
1	14407261	<p>MR Workplace Container, 50cm</p> <p>50 cm wide extra case for the syngo host computer with sliding front door to allow change of storage media (CD/DVD/USB).</p>	\$810
1	14456241	<p>Separator 60kW/75kW #Vi</p> <p>The SEP (Separation cabinet) has to be used if a central hospital chilled water supply is available or if a chiller of any brand/type is already available.</p> <p>The SEP is the interface between the on-site water chiller (of any brand or type) or the interface to the central hospital cooling water supply.</p> <p>For the above-mentioned cases the SEP is mandatory!</p> <p>In these cases, the primary water specifications must fulfill the requirements (i.e. 60 kW (for XK/XQ gradient) / 75kW (for XT gradient) heat dissipation; 100+-10l/min flow; 6 to 14°C (for XQ gradient)/6 to 12°C (for XT gradient) water temperature; pH value 6 to 8, max. working pressure 6 bar).</p> <p>Dimensions: 1950mm x 650mm x 650mm (height x width x depth) Weight: approx. 350kg</p>	\$20,000
1	14456228	<p>System Start Timer #Vi</p> <p>Timer clock that can be installed together with the MAGNETOM MR system to start the system automatically at user-definable times, eliminating waiting times during system boot up.</p>	\$1

Siemens Medical Solutions USA, Inc.
 40 Liberty Boulevard, Malvern, PA 19355
 Fax: (866) 309-6967



SIEMENS REPRESENTATIVE
 Karen Dixon - (865) 360-8644

PRELIMINARY PROPOSAL

Qty	Part No.	Item Description	Extended Price
1	MR_STD_RIG_INST	MR Standard Rigging and Installation MR Standard Rigging and Installation This quotation includes standard rigging and installation of your new MAGNETOM system Standard rigging into a room on ground floor level of the building during standard working hours (Mon. - Fri./ 8 a.m. to 5 p.m.) It remains the responsibility of the Customer to prepare the room in accordance with the SIEMENS planning documents Any rigging requiring a crane over 80 tons and/or special site requirements (e.g. removal of existing systems, etc.) is an incremental cost and the responsibility of the Customer. All other out of scope charges (not covered by the standard rigging and installation) will be identified during the site assessment and remain the responsibility of the Customer.	\$0
1	MR_BTL_INST ALL	MR Standard Rigging & Install	\$27,000
1	MR_PREINST_DOCK	T+D Preinstall kit for dockable table	\$550
1	MR_CRYO	Standard Cryogen	\$8,000
1	MR_PM	MR Project Management A Siemens Project Manager (PM) will be the single point of contact for the implementation of your Siemens equipment. The assigned PM will work with the customer's facilities management, architect or building contractor to assist you in ensuring that your site is ready for installation. Your PM will provide initial and final drawings and will coordinate the scheduling of the equipment, installation, and rigging, as well as the initiation of on-site clinical education.	\$0
1	DTSWO2250M R60	Dimplex chiller - 60 kW The Dimplex Thermal Solutions outdoor, air-cooled, water/glycol chiller has been specially designed for medical applications to provide stable, fully dedicated cooling. 60 kW water/glycol air-cooled heat exchanger/chiller package for outside installation. Features dual tandem refrigerator circuits and dual redundant pumps. Unit also includes fluid reservoir and controls as well as remote control display to monitor the heat exchanger package operation from indoors at the operator's work station. This design also includes the features to meet the specification of OSHPD requirements. For use with Siemens SEP cabinet. Features: Dual 10 hp compressor, dual refrigerant circuits to smoothly transition through the 25 to 100% heat load capacity cycles of patient scanning and idling Energy savings and quiet operation when minimal cooling is required between patient use, and overnight for facilities located amongst residential areas Full capacity cooling enabling optimized utilization Dual, redundant fluid pumps, with automatic switch-over ensures no loss of flow Pricing also includes: Filter & flow meter kit Service package including two start-up visits (one upon cold head start-up, one at commissioning), one PM visit during 12 month P&L warranty period. One year warranty through Dimplex Thermal Solutions. Customer is responsible for rigging and installation. Customer is responsible for providing glycol as specified by the manufacturer. Coastal, low ambient temperature and split chillers are available.	\$54,373

Siemens Medical Solutions USA, Inc.
 40 Liberty Boulevard, Malvern, PA 19355
 Fax: (866) 309-6967



SIEMENS REPRESENTATIVE
 Karen Dixon - (865) 360-8644

PRELIMINARY PROPOSAL

Qty	Part No.	Item Description	Extended Price
1	XPAS_DTS_ST ARTUP	Start-up of DTS chiller	\$0
1	E93PM180UM R	Eaton 93PM-180 kW UPS Complete system backup without interruption. One UPS per MR. Approved for the following systems: Prisma/Prisma Fit (including chiller), Skyra/Skyra Fit (including chiller), Vida XQ (including chiller), Vida XT (excluding chiller), Trio (including chiller), Verio (including chiller), Aera XQ (including chiller), Espree (including chiller), Avanto (including chiller), Sola XQ (including chiller), Lumina (including chiller). Includes the following: Eaton 93PM UPS Electronics Cabinet w/integrated maintenance bypass sidecar Eaton 93PM Single Battery Cabinet System (Full load back-up time @ 180kW of 5.1 minutes.) Network Card Eaton 24x7 start-up One year (24x7) warranty through Eaton Corp. Shipping to the customer's dock. Not approved for sites that require OSHPD. Optional Remote Monitoring Panel Shipment is to customer's dock. Customer is responsible for logistics from the dock to inside location.	\$70,013
1	MR_GOKNEE3 D	GOKnee3D GOKnee3D is a 10-minute, push-button examination for diagnostic imaging of the knee developed and clinically validated by the US board certified MSK radiologists at John Hopkins University Hospital. GOKnee3D exam consists of AutoAlign localizer in the knee, PD weighted contrast and T2 weighted contrast with fat suppression. The AutoAlign technology provides a push-button functionality and ensures consistency in imaging. The 3D protocols are high resolution and isotropic, enabled by SPACE sequence with CAIPIRINHA technique. SW syngo MR E11C AP04 is required for GOKnee3D. Examination time for 3T system is 10 minutes, for a 1.5T system is up to 11 minutes. All given examination times are examination only, adjustments have been excluded. Applies to measurements only with 15channel knee coil.	\$0
1	MRLOC_ABDM DOT	Local Offset - Abdomen Dot Engine	- \$24,300
1	MR_PR_DOTE NG1	Dot Engine 1 pricing offset To be eligible for this promotion, a binding purchase order including the purchase of any DOT Engine must be received by Siemens by September 31, 2019.	\$15,000
1	MRLOC_CARD DOT	Local Offset - Cardiac Dot Engine, USA	- \$36,450
1	MR_PR_DOTE NG2	Dot Engine 2 pricing offset To be eligible for this promotion, a binding purchase order of the application(s) must be received by Siemens Medical on or before September 30, 2019.	\$25,000
1	MR_PR_CC_G PO50	GPO CC Credit FMV\$50K Requires either a 4 year point of sale service agreement, a multi-unit/multi-modality purchase or book and bill	- \$50,000
1	SY_PR_TEAM PLAY	teampay Welcome & Registration Package teampay is a cloud-based network that brings together your imaging modality users, the systems' dose and utilization data, and the users' expertise to help you improve the delivery of care to your patients. Basic features are provided free of charge. Premium features	\$0

Siemens Medical Solutions USA, Inc.
 40 Liberty Boulevard, Malvern, PA 19355
 Fax: (866) 309-6967



SIEMENS REPRESENTATIVE
 Karen Dixon - (865) 360-8644

PRELIMINARY PROPOSAL

Qty	Part No.	Item Description	Extended Price
		(benchmarking, non-Siemens devices) are provided on a trial basis for three months at no charge, and may be used thereafter on a subscription fee basis. To register: http://teampay.siemens.com/#institutionRegistration/1	
1	MR_TRADE_IN _ALLOW	MR Trade-in-Allowance Project# 2018-1719 Deinstall/Expiration date 5/2019 (-\$105,000)	- \$105,000
1	MR_ADDL_RIG GING	Additional Rigging MR \$20,600	\$20,600
System Total:			\$1,495,234

Quotation

Sales Support
tel (800) 633-7231
fax (412) 406-0952
radiologysolutions.bayer.com

Bayer HealthCare LLC
1 Bayer Drive
Indianola, PA 15051



Quote No. Q-00027247

This quotation has been prepared for: Mission Health System Inc

Issued on 4/26/2019

Valid until 6/25/2019

Trade-in required No

Your Bayer Sales Team:

Lauren Baker, , lauren.lee-baker@bayer.com

Quotation Overview

HPG EQUIPMENT Pricing Applied

Bayer's diagnostic imaging products, software, and equipment service help healthcare teams in radiology address their critical performance, quality, uptime, and scheduling requirements.

Please note: If pricing and terms of this [order/quote] are based upon your current Group Purchasing Organization (GPO) affiliation, any change to your current affiliation may require a new quote or updated terms and pricing.

>See [Products and Services Details](#) in this quote for an itemized breakdown of quoted products.

Imaging Products and Services

Product Name	Total List Price	YOUR PRICE
MRXperion - Medrad® MRXperion™ MR Injection System(s) and Related Products/Services	\$57,740.00	\$38,415.00
TOTAL (Local taxes, shipping and/or handling to be invoiced when applicable)	\$57,740.00	\$38,415.00



Products and Services Details

MRXperion - Medrad® MRXperion™ MR Injection System(s) and Related Products/Services

MRXperion™ Injector System

Item(s)	Catalog No.	Qty	Unit List Price	Contracted Price	YOUR PRICE
Medrad® MRXperion® MR Injection System	MRXP 200	1	\$54,950.00	\$35,750.00	\$35,750.00
Installation - Medrad® MRXperion MR Injection System	INS MRXP	1	\$2,400.00	\$0.00	\$2,400.00
2 syringes per kit (115 mL/65 mL), large & small spike, 96" LPCT with T-con and check valve - 20 kits/box	XP 65/115VS	1	\$390.00	\$265.00	\$265.00

Subtotal	\$38,415.00
----------	-------------

TOTAL	\$38,415.00
--------------	--------------------

GRAND TOTAL (Local taxes, shipping and/or handling to be invoiced when applicable)	\$38,415.00
---	--------------------



PHILIPS

Philips Healthcare
3000 Minuteman Road, MS 2214
Andover, MA 01810-1099

Email PO to: Healthcare.Orders@philips.com

or
Fax PO to: 1-800-947-3299

or
Mail PO to:
Philips Healthcare
Order Processing, MS2214
Andover, MA 01810-1099

800-934-7372

QUOTE DATE 04/23/2019	QUOTE NUMBER 2300998133	PAGE 1 / 4
LAST UPDATED 04/23/2019	TIME 19:09:52	
EXPIRATION DATE 06/23/2019	INCOTERMS FOB Destination	
PAYMENT TERMS Net 30 Days Subject to Credit Approval		
FORMAL QUOTE		
CUSTOMER: Attention: Mission Hospital 509 Biltmore Ave ASHEVILLE NC 28801-4601 UNITED STATES Customer Number : 94090104		
SALES REPRESENTATIVE Larry Crosby Ph: (843) 743 - 9788 Fax: QUOTE CONTACT Dana Shaw		Federal EIN: 13-3429115

#	Product	Description	Qty	UoM	Unit Net	Total Net Currency USD
SPECIAL COMMENTS Terms and conditions of Healthtrust contract 500152 prevail.						
10	989803193171 989803193171	Ferrogard Wall-Mounted Assure	1	PCE	31,610.00	31,610.00
		Agreement Discount included in net -30.000 %				
		Promotion discount included in net -12.000 %				
		Net price				31,610.00
		Agreement: GPOHT00010				
		Total Quotation List Price				54,500.00
		Less All Applicable Discounts				-22,890.00
		Total Quotation Net Price				31,610.00
<p>Philips Healthcare is pleased to inform you that financing of its products and services is available to qualified applicants. To obtain more information contact Philips Medical Capital @ 866-513-4PMC.</p> <p>Contract information for: Healthtrust Prices quoted are subject to and reflect applicable discounts per the terms and conditions of the following contract: Contract #500152 Expiration: 01/31/2020</p>						

THIS QUOTATION CONTAINS CONFIDENTIAL AND PROPRIETARY INFORMATION OF PHILIPS HEALTHCARE AND IS INTENDED FOR USE ONLY BY THE CUSTOMER WHOSE NAME APPEARS ON THIS QUOTATION. IT MAY NOT BE DISCLOSED TO THIRD PARTIES WITHOUT PRIOR WRITTEN CONSENT OF PHILIPS HEALTHCARE.



PHILIPS

Philips Healthcare
3000 Minuteman Road, MS 2214
Andover, MA 01810-1099

Email PO to: Healthcare.Orders@philips.com

or
Fax PO to: 1-800-947-3299

or
Mail PO to:
Philips Healthcare
Order Processing, MS2214
Andover, MA 01810-1099

800-934-7372

QUOTE DATE

04/23/2019

QUOTE NUMBER

2300998133

PAGE

1 / 4

LAST UPDATED TIME

04/23/2019 19:09:52

EXPIRATION DATE

06/23/2019

INCOTERMS

FOB Destination

PAYMENT TERMS

Net 30 Days
Subject to Credit Approval

FORMAL QUOTE**CUSTOMER:**

Attention:
Mission Hospital
509 Biltmore Ave
ASHEVILLE NC 28801-4601
UNITED STATES
Customer Number : 94090104

SALES REPRESENTATIVE

Larry Crosby Ph: (843) 743 - 9788

Fax:

QUOTE CONTACT

Dana Shaw

Federal EIN: 13-3429115

#	Product	Description	Qty	UoM	Unit Net	Total Net Currency USD
---	---------	-------------	-----	-----	----------	---------------------------

SPECIAL COMMENTS

Terms and conditions of Healthtrust contract 500152 prevail.

10	989803193171 989803193171	Ferroguard Wall-Mounted Assure	1	PCE	31,610.00	31,610.00
----	------------------------------	--------------------------------	---	-----	-----------	-----------

Agreement Discount included in net -30.000 %

Promotion discount included in net -12.000 %

Net price

31,610.00

Agreement: GPOHT00010

Total Quotation List Price

54,500.00

Less All Applicable Discounts

-22,890.00

Total Quotation Net Price

31,610.00

Philips Healthcare is pleased to inform you that financing of its products and services is available to qualified applicants. To obtain more information contact Philips Medical Capital @ 866-513-4PMC.

Contract Information for: Healthtrust
Prices quoted are subject to and reflect applicable discounts per the terms and conditions of the following contract:
Contract #500152 Expiration: 01/31/2020

THIS QUOTATION CONTAINS CONFIDENTIAL AND PROPRIETARY INFORMATION OF PHILIPS HEALTHCARE AND IS INTENDED FOR USE ONLY BY THE CUSTOMER WHOSE NAME APPEARS ON THIS QUOTATION. IT MAY NOT BE DISCLOSED TO THIRD PARTIES WITHOUT PRIOR WRITTEN CONSENT OF PHILIPS HEALTHCARE.



PHILIPS

Philips Healthcare
3000 Minuteman Road, MS 2214
Andover, MA 01810-1099

Email PO to: Healthcare.Orders@philips.com

or

Fax PO to: 1-800-947-3299

or

Mail PO to:

Philips Healthcare
Order Processing, MS2214
Andover, MA 01810-1099

800-934-7372

QUOTE DATE

04/24/2019

QUOTE NUMBER

2300998509

PAGE

1 / 4

LAST UPDATED TIME

04/24/2019 21:58:03

EXPIRATION DATE

06/24/2019

INCOTERMS

FOB DESTINATION

PAYMENT TERMS

Net 30 Days
Subject to Credit Approval

FORMAL QUOTE**CUSTOMER:**

Attention:
Mission St Joseph Campus
400 Ridgefield Ct
ASHEVILLE NC 28806-2213
UNITED STATES
Customer Number : 94025962

SALES REPRESENTATIVE

Larry Crosby Ph: (843) 743 - 9788

Fax:

QUOTE CONTACT

Dana Shaw

Federal EIN: 13-3429115

#	Product	Description	Qty	UoM	Unit Net	Total Net Currency USD
---	---------	-------------	-----	-----	----------	---------------------------

SPECIAL COMMENTS

Terms and conditions of Healthtrust contract 500152 prevail.

10	989803193171 989803193171	Ferroguard Wall-Mounted Assure	1	PCE	31,610.00	31,610.00
		Agreement Discount Included in net -30.000 %				
		Promotion discount included in net -12.000 %				
		Net price				31,610.00
		Agreement: GPOHT00010				
		Total Quotation List Price				54,500.00
		Less All Applicable Discounts				-22,890.00
		Total Quotation Net Price				31,610.00

Philips Healthcare is pleased to inform you that financing of its products and services is available to qualified applicants. To obtain more information contact Philips Medical Capital @ 866-513-4PMC.

*

Contract information for: Healthtrust

*

Prices quoted are subject to and reflect applicable discounts per the terms and conditions of the following contract:

THIS QUOTATION CONTAINS CONFIDENTIAL AND PROPRIETARY INFORMATION OF PHILIPS HEALTHCARE AND IS INTENDED FOR USE ONLY BY THE CUSTOMER WHOSE NAME APPEARS ON THIS QUOTATION. IT MAY NOT BE DISCLOSED TO THIRD PARTIES WITHOUT PRIOR WRITTEN CONSENT OF PHILIPS HEALTHCARE.



PHILIPS

Philips Healthcare
3000 Minuteman Road, MS 2214
Andover, MA 01810-1099

Email PO to: Healthcare.Orders@philips.com

or
Fax PO to: 1-800-947-3299

or
Mail PO to:
Philips Healthcare
Order Processing, MS2214
Andover, MA 01810-1099

800-934-7372

QUOTE DATE

04/24/2019

QUOTE NUMBER

2300998508

PAGE

1 / 5

LAST UPDATED TIME

04/24/2019 20:45:29

EXPIRATION DATE

06/22/2019

INCOTERMS

FOB Destination

PAYMENT TERMS

Net 30 Days
Subject to Credit Approval

FORMAL QUOTE**CUSTOMER:**

Attention:
Mission Hospital
509 Biltmore Ave
ASHEVILLE NC 28801-4601
UNITED STATES
Customer Number : 94090104

SALES REPRESENTATIVE

Larry Crosby Ph: (843) 743 - 9788

Fax:

QUOTE CONTACT

Dana Shaw

Federal EIN: 13-3429115

#	Product	Description	Qty	UoM	Unit Net	Total Net Currency USD
SPECIAL COMMENTS						
Terms and conditions of Healthtrust contract 500152 prevail.						
10	866185	Expression Patient Monitor (MR400)	2	PCE		
	866185	A01 Standard Accessories	2		0.00	0.00
		F07 Basic + AA,O2,IBP(x2),Temp	2		69,964.44	139,928.88
		Agreement Discount included in net -30.000 %				
		Promotion discount			-6,000.00	-12,000.00
		Special Discount Included in net -5.930 %				
		Net price				127,928.88
		Agreement: GPOHT00010				
20	866428	Expression MR400 Accessories	2	PCE		
	866428	F17 Adult F07 Access.	2		1,503.72	3,007.44
		F27 Pediatric F07 Access.	2		1,490.27	2,980.54
		F37 Infant F07 Access.	2		1,487.06	2,974.12
		F47 Neonatal F07 Access.	2		1,417.23	2,834.46
		H01 Power	2		825.22	1,650.44
		H02 Patient Connections	2		5,128.16	10,256.32
		H03 Pat. Connections - ECG CV	2		1,025.12	2,050.24

THIS QUOTATION CONTAINS CONFIDENTIAL AND PROPRIETARY INFORMATION OF PHILIPS HEALTHCARE AND IS INTENDED FOR USE ONLY BY THE CUSTOMER WHOSE NAME APPEARS ON THIS QUOTATION. IT MAY NOT BE DISCLOSED TO THIRD PARTIES WITHOUT PRIOR WRITTEN CONSENT OF PHILIPS HEALTHCARE.



PHILIPS

Philips Healthcare
 3000 Minuteman Road, MS 2214
 Andover, MA 01810-1099

QUOTE DATE 04/24/2019	QUOTE NUMBER 2300998508	PAGE 2 / 5
LAST UPDATED 04/24/2019	TIME 20:45:29	
EXPIRATION DATE 06/22/2019	INCOTERMS FOB Destination	
FORMAL QUOTE		

#	Product	Description	Qty	UoM	Unit Net	Total Net Currency USD
		H04 Pat. Connections - ECG Std	2		1,025.12	2,050.24
		H05 Pat. Connections - ECG Neo	2		1,025.12	2,050.24
		H06 Pat. Connections - IBP	2		224.25	448.50
		H07 Pat. Connections - Temp	2		864.95	1,729.90
		Agreement Discount included in net -30.000 %				
		Special Discount included in net -5.930 %				
		Net price				32,032.44
		Agreement: GPOHT00010				
30	865471 865471	Expression Information Portal (IP5)	1	PCE	8,008.75	8,008.75
		A01 Standard Accessories	1		0.00	0.00
		Agreement Discount included in net -30.000 %				
		Special Discount included in net -5.930 %				
		Net price				8,008.75
		Agreement: GPOHT00010				
40	865471 865471	Expression Information Portal (IP5)	1	PCE	8,008.75	8,008.75
		A01 Standard Accessories	1		0.00	0.00
		Agreement Discount included in net -30.000 %				
		Special Discount included in net -5.930 %				
		Net price				8,008.75
		Agreement: GPOHT00010				
		Total Quotation List Price				293,396.00
		Less All Applicable Discounts				-117,417.18
		Total Quotation Net Price				175,978.82

Philips Healthcare is pleased to inform you that financing of its products and services is available to qualified applicants. To obtain more information contact Philips Medical Capital @ 866-513-4PMC.

THIS QUOTATION CONTAINS CONFIDENTIAL AND PROPRIETARY INFORMATION OF PHILIPS HEALTHCARE AND IS INTENDED FOR USE ONLY BY THE CUSTOMER WHOSE NAME APPEARS ON THIS QUOTATION. IT MAY NOT BE DISCLOSED TO THIRD PARTIES WITHOUT PRIOR WRITTEN CONSENT OF PHILIPS HEALTHCARE.



650 Ford Street
 Colorado Springs, CO 80915 USA
 Email: medicalsales@harloff.com
 Tel: 1.719.637.0300
 Fax: 1.719.597.8273
 Manufactured with Pride in Colorado Springs

QUOTE

Quote # DW042219MI
Date 04/22/19
Sales Rep. Deven Willis

Quote To:
 Mission Health
 Chris Chandler

 Asheville
 NC 28801

 (828) 213-1370

Ship To:
 Mission Health
 Chris Chandler

 Asheville
 NC 28801

 (828) 213-1370

Manufactured With Pride in Colorado Springs
 12 Year Manufacturers Warranty
 1 Year Warranty on Purchased Parts

Please Include Color Choice

3 Week Lead Time for Production
 Shipping Lane 3-4 Days

Freight Estimated Via Fed Ex
 Liftgate Included at No Additional Charge

Qty	Harloff Part #	Description	Unit List	Unit Price	Ext. Price
1	MR6B	MR-Conditional 6 Drawer Emergency Cart with Breakaway Lock; 100 Breakaway Seals, 1-4", 2-3.25", 2-6.5", and 1-9.75" Drawers	\$4,109.00	\$3,081.75	\$3,081.75
				SubTotal	\$3,081.75
				Freight Estimate	\$225.00
				Total	\$3,306.75

Color and any Special Instructions must be specified on the Purchase Order.
Terms: Net 30 Days with approved Credit. If Credit is not approved Terms of Purchase can be by Credit Card or ACH.
Shipment: Standard Harloff lead time unless otherwise requested and confirmed.
Freight: FOB Factory, prepaid and added to the invoice.
Freight estimates are good faith estimates only and actual charges may be higher and lower.

Quote is valid for 90 days; Prices subject to change thereafter. Prices based upon total purchases; reduced final quantity may increase price.
All orders subject to Harloff's Terms and Conditions of Sale. Confirmed Purchase Orders subject to cancellation fees.
TWELVE (12) YEAR MANUFACTURERS WARRANTY; does not include incidental or consequential merchantability or fitness of purpose.
ONE (1) YEAR LIMITED WARRANTY on purchased parts and hardware.



QUOTATION

DIRECT SALES DIVISION

3371 Executive Way
Miramar, FL 33025

Phone: (888) 430-9559

Fax: (888) 430-9560

Quote Number	1161938
Quote Date	4/25/2019
Prepared By	TTHOMAS
Quote Expiration Date	5/31/2019
GPO Price	HPG
Terms	Net 30
Freight	Prepaid and Added to Invoice

Customer ID: 32246

Ship To ID: 32247

COID: 27610

MISSION HOSPITAL
ATTN: ACCOUNTS PAYABLE
400 RIDGEFIELD COURT
ASHEVILLE, NC 28806

MISSION HOSPITAL
509 BILTMORE NORTH DOCK
8 HOSPITAL DRIVE
ASHEVILLE, NC 28801

Requested By: PAULA BRANSON

Quantity	UOM	Item / Description	Unit Price	Extended Price
1	EA	4551WC1024 WHEELCHAIR MRJ NON-MAGNETIC 24IN W X 18IN D, DETACHABLE FOOTREST AND DETACHABLE DESK ARMS BURGUNDY UPHOLSTERY 350LB CAPACITY	2,316.28	2,316.28
1	EA	4551ST2004 STRETCHER NON-MAGNETIC MRJ FIXED GURNEY WITH FOWLER CRANK ASSEMBLY 30"W X 77-1/2"L X 30-1/4"H, 3" BLACK PAD COVERED WITH MEDICAL GRADE SURE-CHECK FUSION III MATERIAL, 22" X 31" STORAGE TRAY BELOW, (4) 5" LOCKING CASTERS, GROUNDING CHAIN, STAINLESS STEEL CONSTRUCTION, DROP-DOWN SIDE RAILS, ADJUSTABLE HEADREST, 600LB WEIGHT CAPACITY, MODEL ST-2004 MRIEQUIP	3,590.78	3,590.78

SUB-TOTAL:	5,907.06
TAX AMOUNT:	413.49
TOTAL:	6,320.55

New Online Product Request NOW AVAILABLE at
www.kermamedical.com
THANK YOU FOR YOUR BUSINESS!!

ATTACHMENT 4

January 16, 2019

Mrs. Rita Edwards
Chief Ancillary Officer
Mission Health System, Inc
509 Biltmore Avenue
Asheville, NC 28801

Dear Mrs. Edwards:

This letter is to inform you that Siemens Healthineers will be removing the Philips Inginia 3T from Mission Hospital on trade as part of the purchase of the Siemens Sola MR (Quote # 1-OPNSMC). The Philips Inginia 3T will be returned to Siemens and will not be reinstalled in the state of NC without the proper CON.

Please let me know if you have any questions or concerns.

Approved:

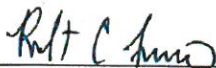

Bob Ferrero
Zone Finance VP



Francois Nolte
Zone General Manager

ATTACHMENT 5

MISSION HOSPITAL
FOR ADVANCED MEDICINE

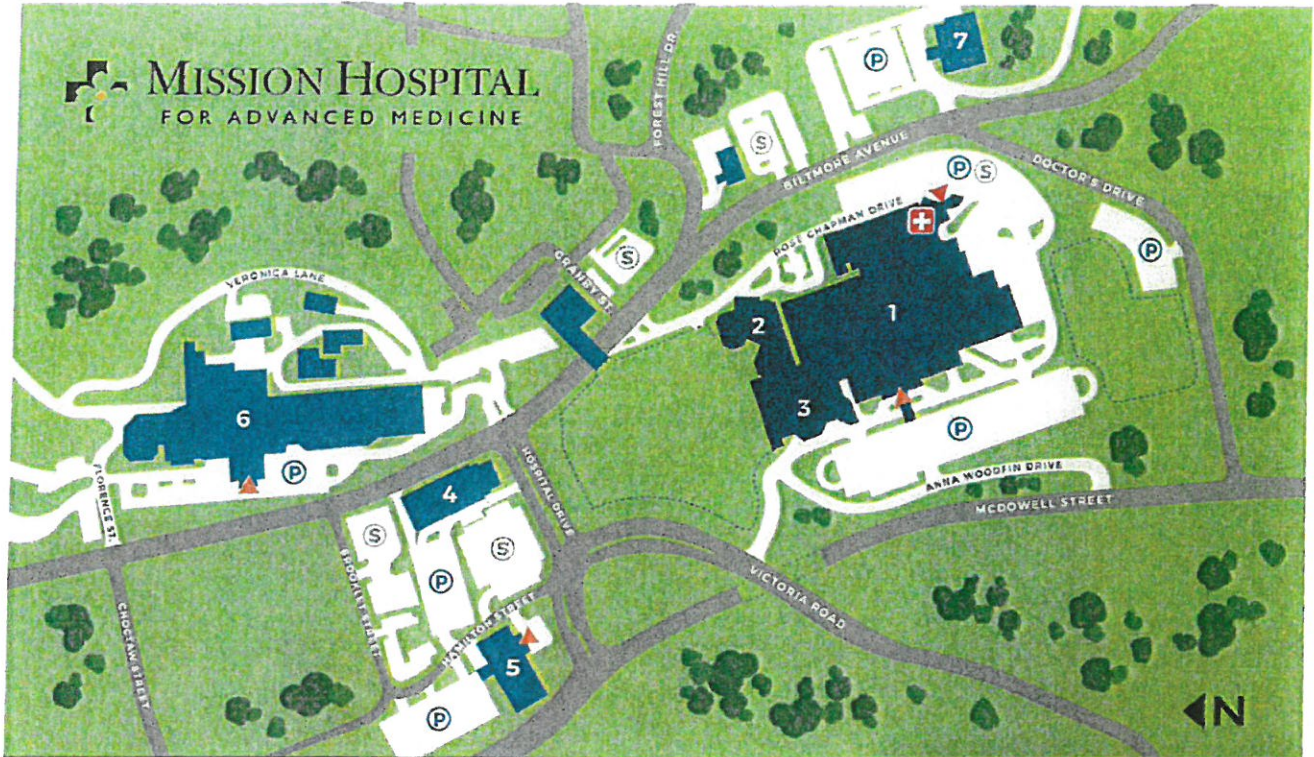

LEGEND

- Main Hospital
- Mission Health Facility
- Main Entrance
- Visitor Parking
- Staff Parking
- Emergency Department

FACILITIES

- | | |
|------------------------------|--|
| 1 Memorial Campus | 5 SECU Cancer Center |
| 2 Owen Heart Center | 6 St. Joseph Campus |
| 3 Outpatient Services | 7 Mission Imaging and Breast Center |
| 4 1 Hospital Drive | |



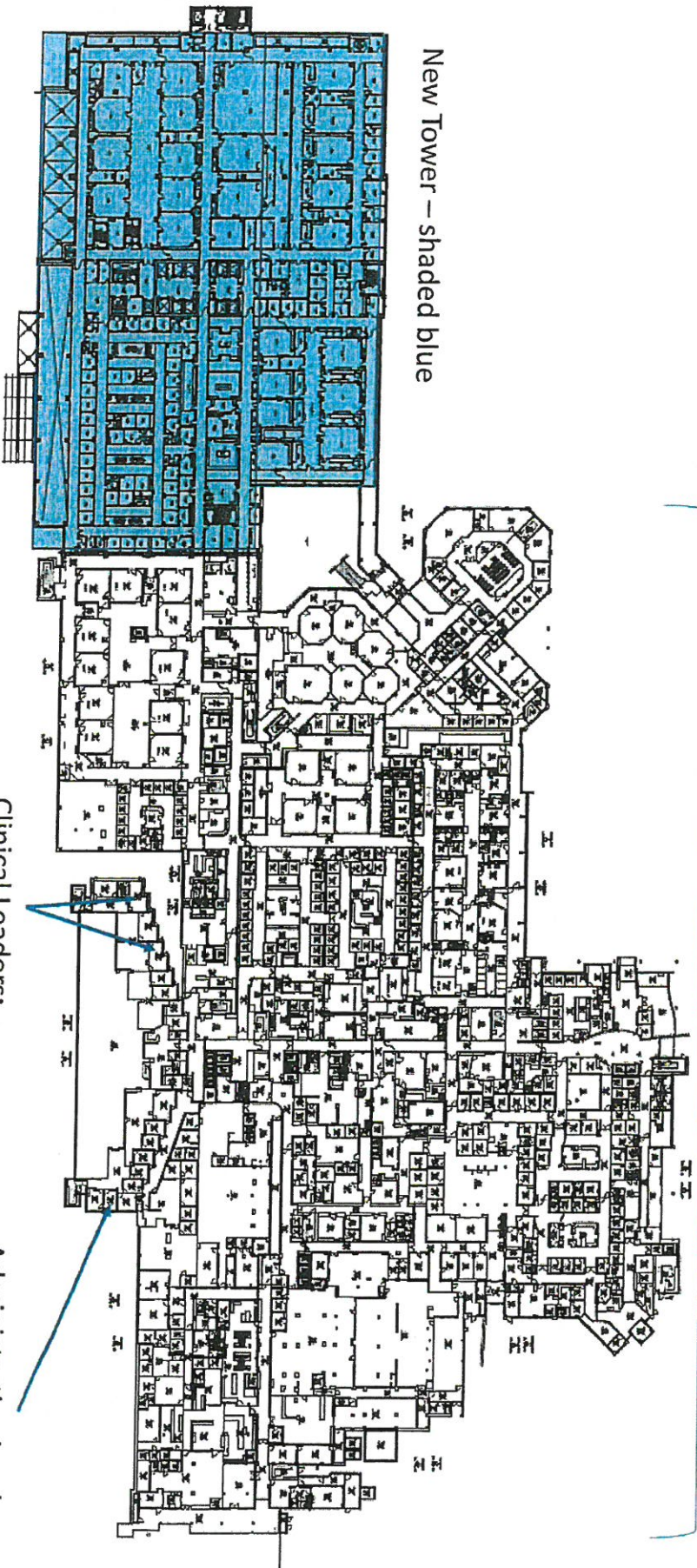

New Tower — shaded blue

Existing Campus — unshaded

Clinical Leaders:
Ruth Zyry, COO
Karen Olsen, CNO

Administrative Leader:
Jill Hoggard Green,
President

ATTACHMENT 6

STATE OF NORTH CAROLINA

*Department of Health and Human Service
Division of Health Service Regulation*

CERTIFICATE OF NEED

for

Project Identification Number #B-8459-09

FID #943349

ISSUED TO: Mission Hospital, Inc.
509 Biltmore Avenue
Asheville, NC 28801

Pursuant to N.C. Gen. Stat. § 131E-175, et. seq., the North Carolina Department of Health and Human Services hereby authorizes the person or persons named above (the "certificate holder") to develop the certificate of need project identified above. The certificate holder shall develop the project in a manner consistent with the representations in the project application and with the conditions contained herein and shall make good faith efforts to meet the timetable contained herein. The certificate holder shall not exceed the maximum capital expenditure amount specified herein during the development of this project, except as provided by N.C. Gen. Stat. § 131E-176(16)e. The certificate holder shall not transfer or assign this certificate to any other person except as provided in N.C. Gen. Stat. § 131E-189(c). This certificate is valid only for the scope, physical location, and person(s) described herein. The Department may withdraw this certificate pursuant to N.C. Gen. Stat. § 131E-189 for any of the reasons provided in that law.

SCOPE: Mission Hospital, Inc. shall replace fixed MRI scanner/ Buncombe County

CONDITIONS: See Reverse Side

PHYSICAL LOCATION: Mission Hospital, Inc.
509 Biltmore Avenue
Asheville, NC 28801

MAXIMUM CAPITAL EXPENDITURE: \$4,094,000

TIMETABLE: See Reverse Side

FIRST PROGRESS REPORT DUE: September 1, 2010

This certificate is effective as of the 4th day of May, 2010.



Chief, Certificate of Need Section
Division of Health Service Regulation

CONDITIONS:

1. Mission Hospital, Inc. shall materially comply with all representations made in its certificate of need application.
2. Mission Hospital, Inc. shall not acquire, as part of this project, any equipment that is not included in the project's proposed capital expenditure in Section VIII of the application or that would otherwise require a certificate of need.
3. Mission Hospital, Inc. shall acknowledge acceptance of and agree to comply with all conditions stated herein to the Certificate of Need Section in writing prior to issuance of the certificate of need.

A letter acknowledging acceptance of and agree to comply with all conditions stated in the conditional approval letter was received by the Certificate of Need Section on March 14, 2010.

TIMETABLE:

Approval of Final Drawings and Specifications	
by Construction, DHSR _____	July 1, 2010
25% Completion of Construction _____	August 08, 2010
50% Completion of Construction _____	September 15, 2010
75% Completion of Construction _____	October 23, 2010
Completion of Construction _____	November 30, 2010
Occupancy/Offering of Service(s) _____	January 31, 2011